



Completion Date	December 2007
Cost	\$10,000,000
Project Type	Commercial Center
Client	Avalon Group



Plaza at Mill Town

Waipahu, Oahu, Hawaii

Situated between the Waipahu Mill Town Industrial development and historic Waipahu Sugar Mill, this 1.9 acre 30,000 sf proposed commercial development includes a family dining restaurant and support services in addition to the planned retail and office tenants. The project will fulfill a need caused by the increase in the district's resident population coupled with an existing shortage of retail and office facilities. Parking is on-grade with two levels of retail and office suites above. The casual dining restaurant would service the day working population of the Mill Town industrial complex, as well as the resident population.

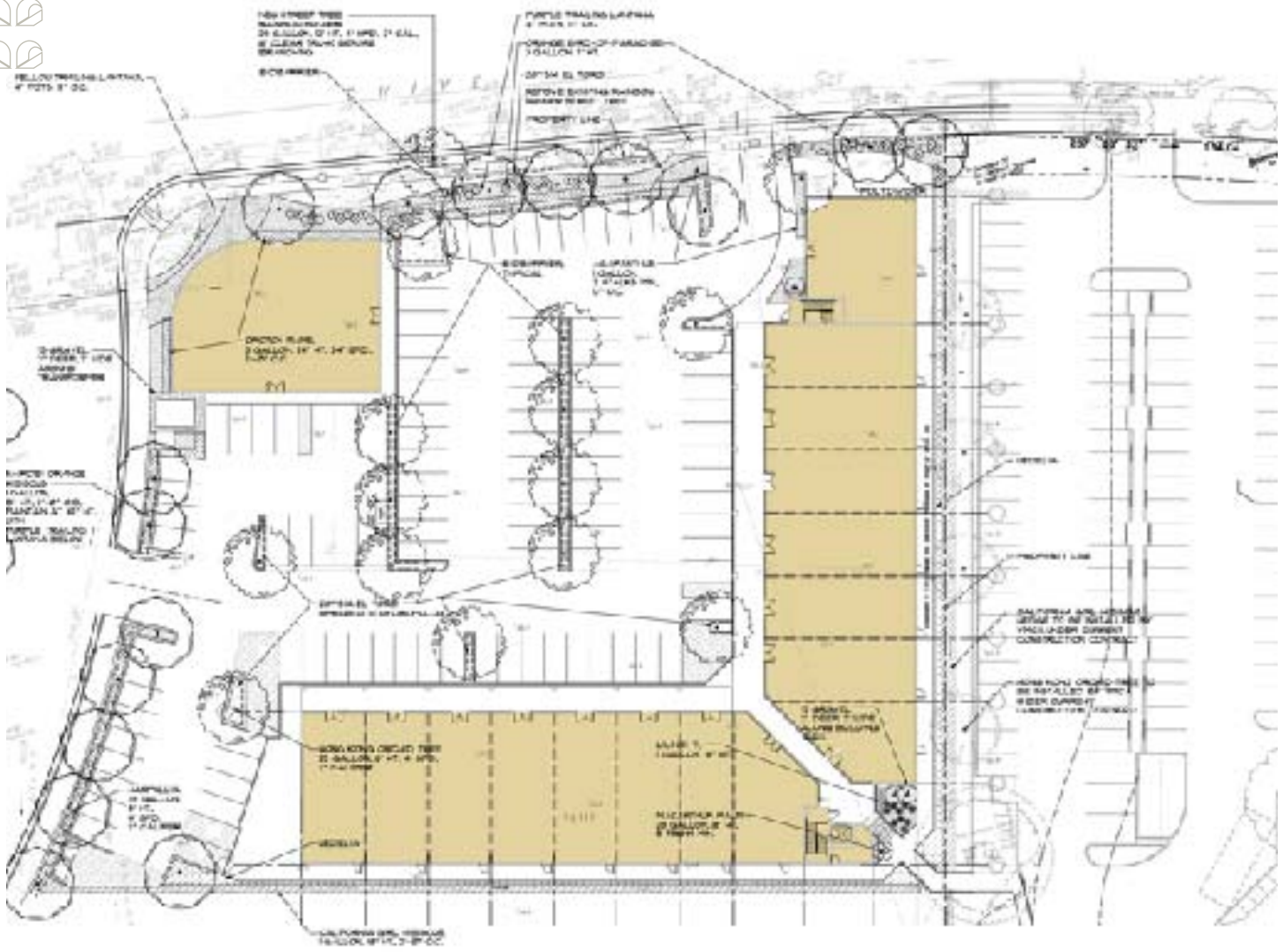

Plaza at Mill Town

Waipahu, Oahu, Hawaii

